

CARDONE ProTech

Supporting Today's Professional Technician



TROUBLESHOOTING CHRYSLER POWER STEERING GEAR BOXES

Application: Chrysler vehicles 1962-1972 (27-6546), 1975-1988 (27-6542)

Problem: Whine or growl noises.
Poor steering return.
Hard steering or lack of assist.
Binding in steering or leakage.

Cause: Sticking Power Piston or restriction in Control Valve Body.

Solution: Disassemble *Control Valve Body*. Clean & inspect all parts. Flush system thoroughly and bleed according to manufacturers specifications.

NOTE: *Control Valve body may not be supplied with your replacement gear box. Do not transfer part until thoroughly flushed*

Note: Do not tamper with *steering valve body*, this is pre-set at the factory.

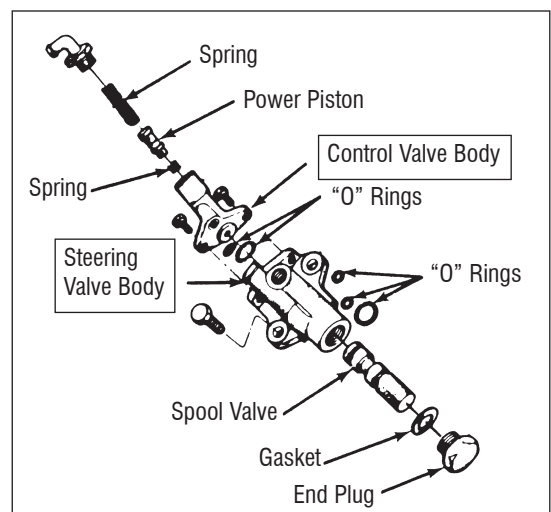
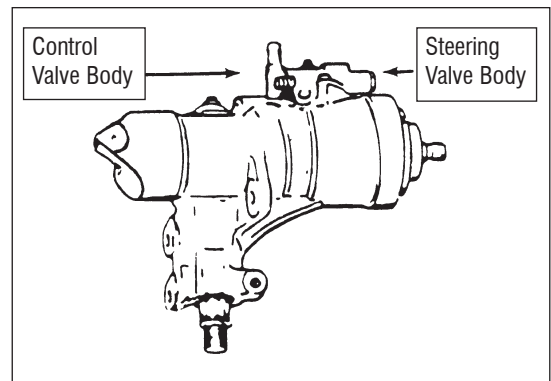

For other ProTech publications, visit www.cardone.com
CARDONE Industries, Inc. • 5501 Whitaker Ave. • Philadelphia, PA 19124-1799

Made by O.E. Remanufactured Best by **CARDONE**[®]

Power Steering Pumps

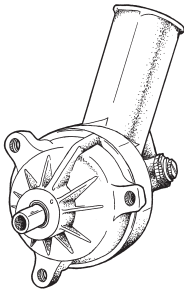

- Control Valves
- Power Cylinders
- Power Steering Pumps
-Filters
- Rack & Pinion Units
- Steering Gears

Cam Rings - In order to prevent low flow, noise, or no pressure, CARDONE resurfaces the cam ring to give it the original, consistent surface. By running your finger around the inside of the cam ring, you will be able to feel the smooth inner surface. Every unit is tested for proper flow and pressure to make sure it meets all OEM specifications. This process ensures a high quality unit that won't come back.

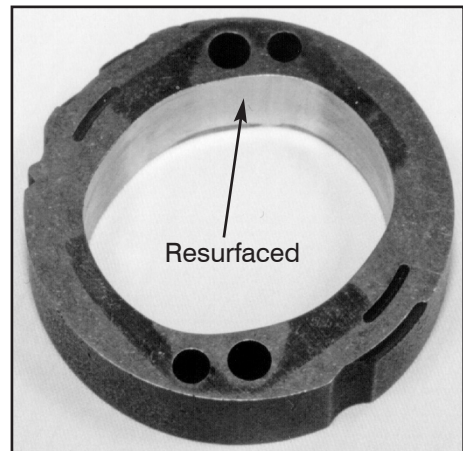

- Limited lifetime warranty
- Contact your local auto parts store or visit our web site, **www.cardone.com**, for more information on this and other CARDONE products today!